

District Newsletter

CAPITAL IMPROVEMENT PROJECT

School Repairs and Renovations

Construction, installation, and equipment of renovations, alterations and improvements of the Wheatland-Chili Middle/High School, the T. J. Connor Elementary School, and the Bus Garage Facility, including site improvements for various school purposes and improvements to the athletic facilities at Middle/High School.

THE CAPITAL PROJECT WAS CAREFULLY PLANNED:

- Timed to have the least financial impact on taxpayers due to the retiring of existing debt;
- Based on 2015 Building Condition Survey submitted to the State Education Department; and
- Focused on energy efficiency, health/safety, asset preservation/maintenance, technology/communications, accessibility upgrades, and site work.

THE CAPITAL PROJECT IS FISCALLY RESPONSIBLE:

- Funded by 71.4% State Building Aid and \$1,663,000 Capital Reserve Fund; and
- Through the combined impact of **retiring debt**, the use of **excess building aid** from prior projects, and the **use of capital reserve funds**, taxpayers will see a **0% increase in taxes**.



Fact Sheet

Cost of Project

\$11,113,000

NYS Building Aid

71.4 %

Local Share

28.6 %

Project is offset by Capital Reserve Funds

\$1,663,000

Average Cost to Homeowner

Through the combined impact of **retiring debt** and the **use of capital reserve funds**, taxpayers will see a **0% increase in taxes**.

PUBLIC INFORMATION MEETINGS

Tuesday, November 28, 2017

7:00 pm,
MS/HS Auditorium

Tuesday, December 5, 2017

7:00 pm,
Board of Education
Conference Room, third floor
at T. J. Connor Elementary



December 14, 2017

7 a.m. – 9 p.m.

Middle/High School Gymnasium
940 North Road, Scottsville

SUMMARY OF PROPOSED ALTERATIONS @ TJ CONNOR ELEMENTARY

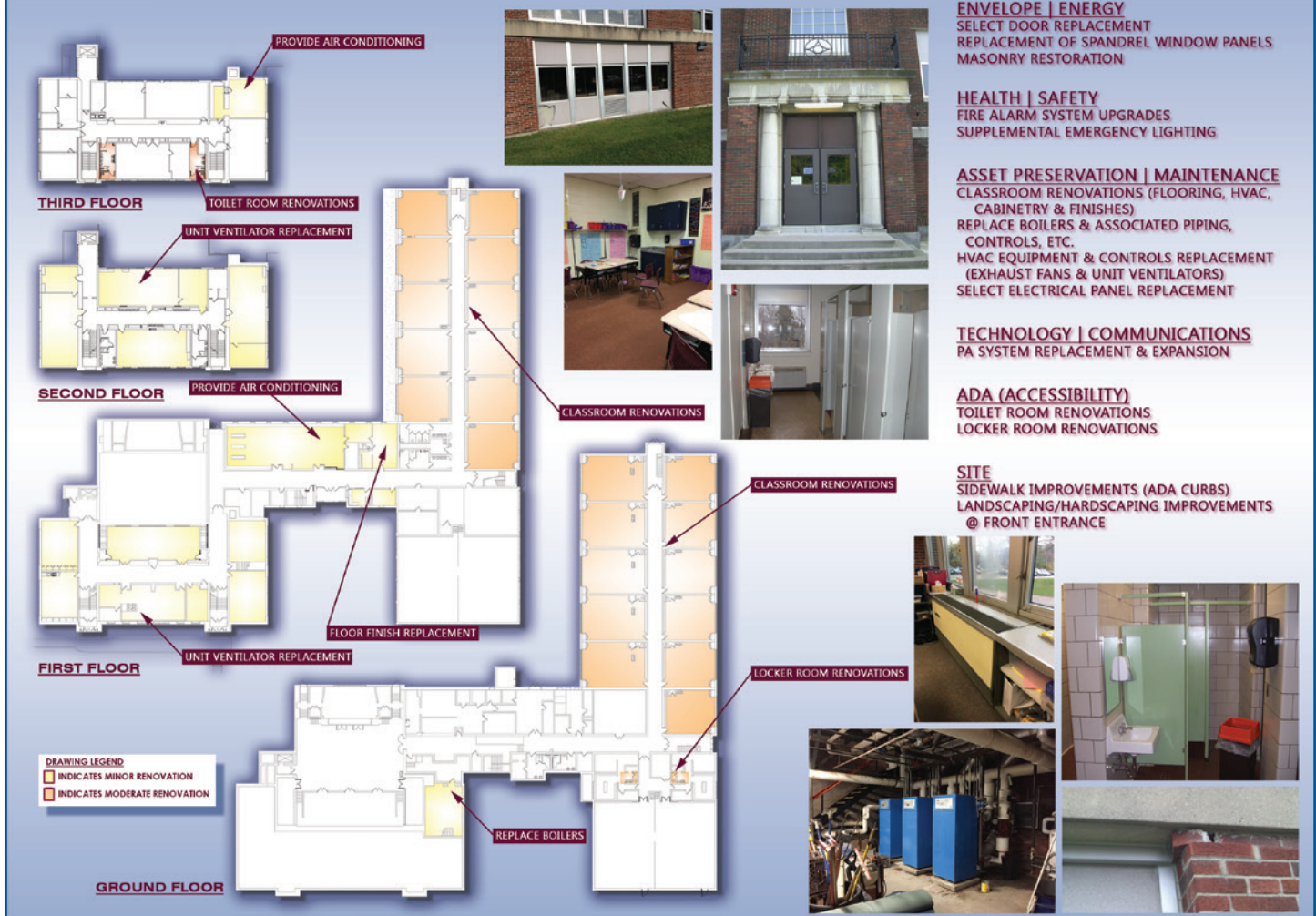

Why is this capital improvement project needed?

The District provides services in over 280,000 square feet of facilities on two different sites. Most of the project scope was assembled through the 2015 Building Condition Survey (required by NYS every five years) intended to identify deficiencies in areas such as: energy efficiency, health, safety, code improvements, asset preservation, and accessibility upgrades. Just like your own home, the District maintenance efforts combined with planned capital improvement projects help keep our facilities and programs running safely and effectively.

We also have an aging gymnasium in the District with no major upgrades in many years. This project will provide a new floor, new bleachers, and renovation to the ceiling. In addition, the windows will be replaced.

How will the capital improvement project be funded?

The revenue necessary to fund this project is shown in the graph. The majority of funding will be provided by New York State in the form of building aid (estimated at 71.4%). The remaining 28.6% will be paid locally. The local share of the project is offset by retiring debt service, excess building aid from prior projects, and capital reserve funds in the amount of \$1,663,000. This allows the project to be funded without any additional tax increases.

How will the capital improvement project impact my taxes?

There will be no increase in your taxes for this project.

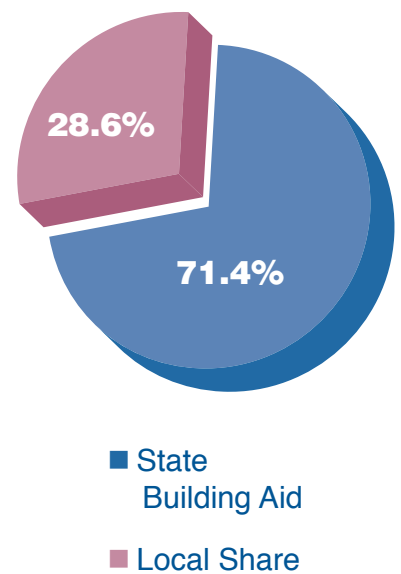

SUMMARY OF PROPOSED ALTERATIONS @ THE MIDDLE|HIGH SCHOOL



ENVELOPE | ENERGY
SELECT DOOR REPLACEMENT
REPLACEMENT OF SPANDREL WINDOW PANELS
LIBRARY WINDOW REPLACEMENT

HEALTH | SAFETY
FIRE ALARM SYSTEM UPGRADES
REPLACEMENT OF POOL LIGHTING

ASSET PRESERVATION | MAINTENANCE
RENOVATIONS TO THE BOYS & GIRLS GYM LOCKER ROOMS
GYM RENOVATIONS (CEILING IMPROVEMENTS, BLEACHER, FLOOR & WINDOW REPLACEMENT)
POOL FINISH IMPROVEMENTS
REPLACE BOILERS & ASSOCIATED PIPING, CONTROLS, ETC.
HVAC EQUIPMENT & CONTROLS REPLACEMENT (AIR HANDLING UNITS, EXHAUST FANS & UNIT VENTILATORS)

TECHNOLOGY | COMMUNICATIONS
PA SYSTEM REPLACEMENT & EXPANSION
CLOCK SYSTEM REPLACEMENT

ADA (ACCESSIBILITY)
PAVING/SIDEWALK IMPROVEMENTS

SITE
ADDITION OF SCOREBOARD @ VARSITY
SOFTBALL FIELD
NEW SIDEWALK ALONG CHILI AVE.
SANITARY MAIN IMPROVEMENTS

BUS GARAGE
FIRE ALARM SYSTEM UPGRADES
VEHICLE LIFT REPLACEMENT
SUPPLEMENTAL SECURITY LIGHTING
EXHAUST SYSTEM IMPROVEMENTS

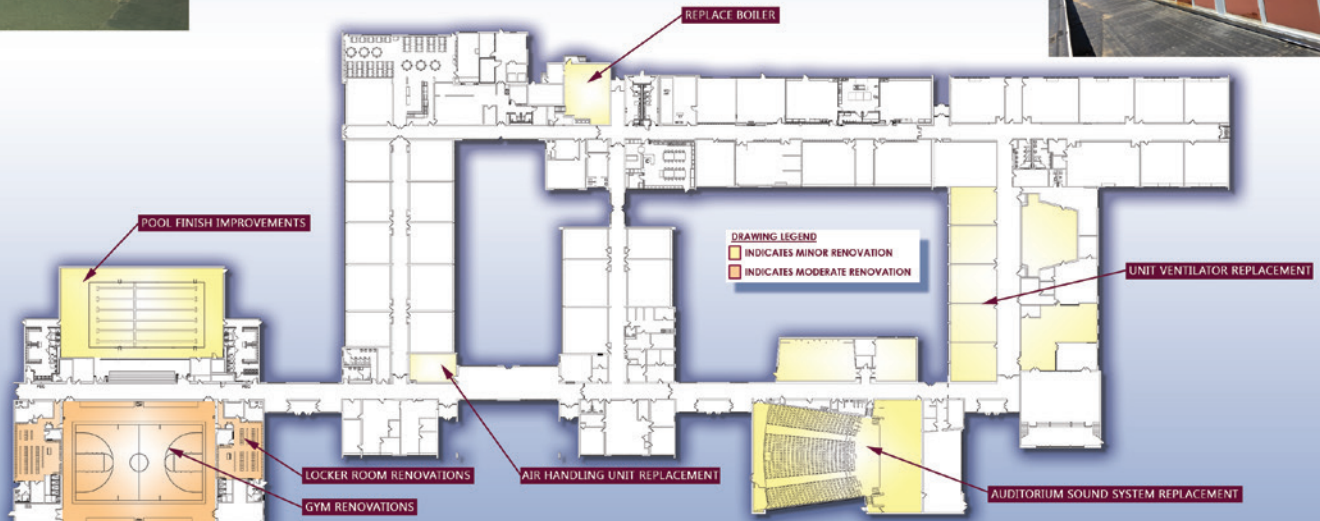

When will this work occur?

This project will be completed in two phases as follows:

- Early Phase 1 – Gymnasium project to be submitted as an expedited project to the State Education Department, with anticipated construction during summer 2018;
- Phase 2 – Anticipated construction during summer 2019; and
- Phase 3 – Anticipated construction during summer 2021.

What happens if the project is not approved?

With an approved capital project, 71.4% of the cost of the improvements will be reimbursed through state building aid. If the capital project is not approved, 100% of the costs of any renovations, alterations, or improvements would be included in the school budget without additional state building aid for the capital expenses.

The inefficiencies associated with operating/maintaining equipment and systems beyond their useful life may divert resources from the operational budget as the district would be forced to repair or replace those items as they fail. Planned Capital Improvements are a proactive way to maintain our exceptional facilities and have less cost impact to those we serve than would reactionary repair/replacement efforts throughout the year.

Project Timeline:

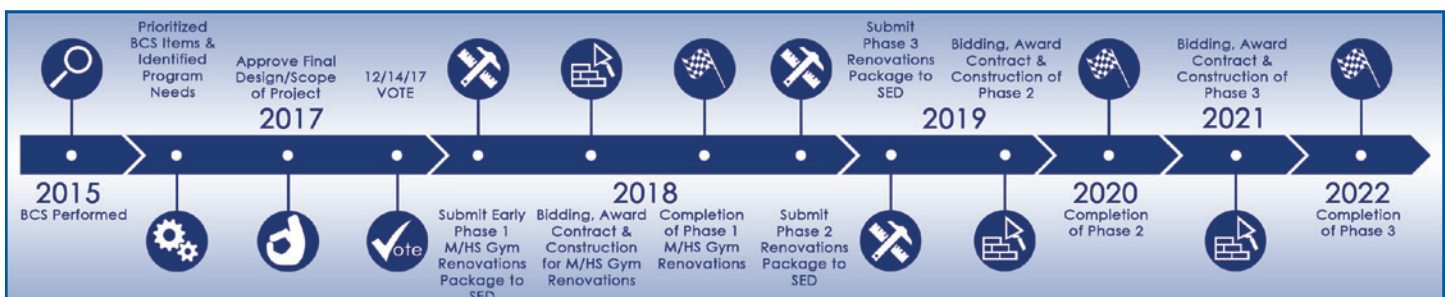

Wheatland-Chili Central School District

13 Beckwith Avenue
Scottsville, NY 14546
585.889.6247

Board of Education (2017-2018)

James Musshafen, President
Shanna Fraser, Vice President
Gregory Berl
Beth Nolan
Courtney Panek
Tiffany Passmore
Michelle Rocha

Superintendent

Dr. Deborah Leh

Non-Profit Org.
U.S. POSTAGE
PAID
Henrietta, N.Y.
Permit No. 7

BOXHOLDER
SCOTTSVILLE NY 14546

On Thursday, December 14, 2017, polls will be open for the Wheatland-Chili Central School District community to vote on a capital improvement project. The proposition results from the 2015 Building Condition Survey reports required by New York State; organizing of the Building Condition Survey reports into the categories of **envelope/energy improvements, health/safety, asset preservation/maintenance, technology/communications, accessibility upgrades, and site work**; prioritizing of the work to be accomplished in the different categories by the Facilities Committee and the Board of Education members; and through community input.

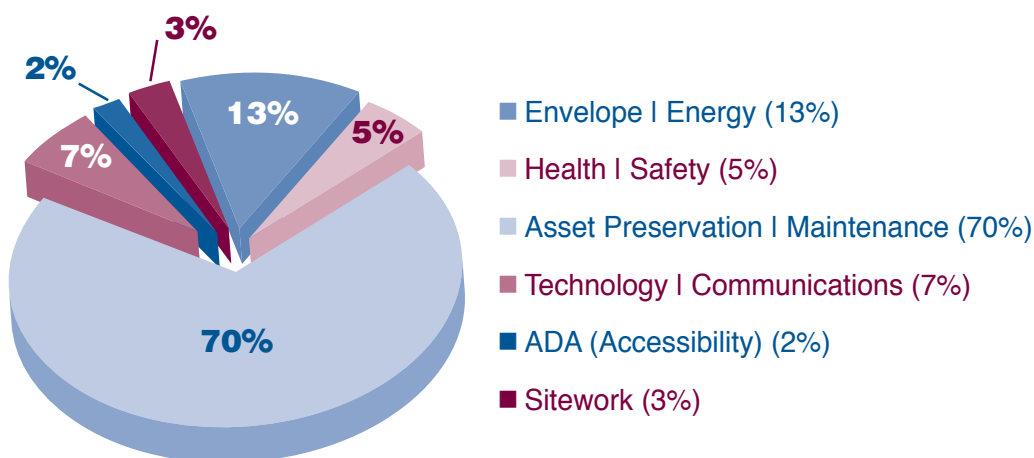
**Facilities
Committee Members**

Maggie Augugliaro
Gregory Berl
Patricia Bruno
Dennis Draper
Michael Ebertz
Deanie Estes
Cynthia Kwiatkowski
Deborah Leh
Scott Melville
Brad Moreland
James Musshafen
Gary O'Donnell
Jon Reid
Jeffrey Smith
Eric Windover
Margaret Wright



December 14, 2017

7 a.m. – 9 p.m.

Middle/High School Gymnasium
940 North Road, Scottsville

If you have questions, please call Superintendent Deborah Leh at 585.889.6246 or visit our website at www.wheatland.k12.ny.us.